

ADDENDUM No. 1  
TO THE  
CONTRACT DOCUMENTS FOR CONSTRUCTION OF  
AIRPORT PARKING LOT IMPROVEMENTS  
PROJECT #20PW22

THIS ADDENDUM IS HEREBY MADE A PART OF THE CONTRACT DOCUMENTS DATED  
January 21<sup>st</sup>, 2021, TO THE SAME EXTENT AS THOUGH IT WERE ORIGINALLY  
INCLUDED THEREIN.

ISSUED THIS 5<sup>TH</sup> DAY OF FEBRUARY, 2021.

CITY OF ROSEBURG  
PUBLIC WORKS DEPARTMENT  
900 SE DOUGLAS AVENUE  
ROSEBURG, OREGON 97470  
(541) 492-6730

This addendum forms a part of the Contract Documents and modifies the original Bidding Documents dated January 21<sup>st</sup>, 2021 as noted below. Acknowledge receipt of this addendum in the space provided on the Bid Form. Failure to do so may subject the Bidder to disqualification.

### **CONTRACTOR QUESTIONS**

1. Is the 12" topsoil section in the planters in front of the FBO building intended to be incidental to something since there is no bid item?
  - a. Yes, the 12" topsoil section in the planters is incidental and not intended to be listed in the bid schedule.*
2. Is the rock under sidewalk also incidental since there is no bid item?
  - a. Yes, the aggregate under the new sidewalk is incidental.*
3. Are all demo items incidental since there is no bid item?
  - a. Yes, all demo is incidental.*
4. There is no surface hatching under the alternate gate location but the sawcut is north of the gate. I am assuming this gets paved since the crosswalk paint goes through this area.
  - a. Yes, this should be re-paved as the existing slope slightly exceeds the maximum 8.3% ramp run. See updated sheet #4.*
5. I am assuming it is your intent to not have any import or export associated with the 4" asphalt section area.
  - a. There may be some import of agg base – see bid item #5 and general comment below. There will most likely be some export of existing aggregate in 4" asphalt section area – review sheet #3 Grading Plan.*
6. There is no bid item for topsoil (note 3 on sheet 5), will any topsoil be required for this job?
  - a. Yes topsoil is required. See answer to question #1*
7. What permits and at what cost are required for this job (note 9 on sheet 1)?
  - a. There are no permits required by the City for this job.*

8. Note 18 on sheet 1 calls for all water on new paving to drain to the new catch basin, the finish grades on sheet 3 don't seem to allow for that?

*a. Disregard note 18 on sheet 1, it has been removed – see updated sheet.*

9. Under which bid item will the excavation in the areas shown on the landscape plan to receive rock be paid?

*a. There is no excavation shown on the landscape plan to receive rock. It is shown on note 1 on the grading plan (Sheet 3). Payment for excavation will be incidental.*

10. In the bid schedule there is a "5%" in the mobilization bid item, what does this refer to?

*a. This refers to nothing and has been removed – see revised bid schedule.*

11. Is the City providing any construction survey/staking?

*a. The City will provide some staking for the accessible ADA path from the sidewalk to the building entrance. The City will also provide some staking for the new catch basin location.*

12. Where will the new fencing be install if that option is taken (note 19 on sheet 4 is missing from the plan view)?

*a. Note 19 has been added to updated sheet #4.*

13. The specs indicate any required testing cost will be borne by the contractor, can you specify what testing you will require?

*a. The testing that the City will require will be proof rolling of regraded aggregate base and density testing of the new asphalt lifts.*

14. Will the reflectivity requirements of Sec 860 be required for the parking lot striping?

*a. No reflectivity requirements of Sec 860 will be required.*

15. Sheet 4/7 shows #8 on the right side of the page as mon curb and sidewalk. Looks like it should be 6' sidewalk #9

*a. This should be #9 and has been changed – see updated sheet #4.*

16. Number 14 is streetside sw and curb. The details shows it as C&G. Specs say to dowel it to the existing curb. Do we just pour sidewalk then?

*a. Yes, the existing curb remains and only the sidewalk is to be replaced.*

17. Clarify please at the ADA ramps is there a need for a landscape curb at the back of walk?

*a. No curb is required at the back of walk.*

18. #18 shows 3 separate places for 12" stand curb and only 8 lf. I need more detail.

*a. There are three locations of the 12" standard curb that amount to 12 lf. Bid schedule and sheet have been updated.*

19. What size backflow device is needed and what manufacturer?

*a. A 1" double check valve assembly is required. There are no specific manufacturer required; just as long as it's an approved device deemed by the State of Oregon plumbing code.*

### **BID FORM**

**DELETE** the Bid Form in its entirety and **REPLACE** with the attached revised Bid Form. A new bid schedule is attached. A bid not including this new bid schedule will be rejected as nonresponsive.

### **DRAWINGS**

**REPLACE** Sheets 1, 3, and 4 with the attached revised Sheets 1, 3 and 4.

### **GENERAL COMMENTS/CLARIFICATION**

- Removed 10' of 6" curb from bid schedule and Sheet #4 – see note #5
- Added 4' of 12" standard curb to bid schedule.
- Added Aggregate base to the bid schedule. If needed, this is exclusively for fine grading of base rock of new asphalt parking area.

Attachments: New Bid Form  
Revised Sheets 1, 3, and 4

**END OF ADDENDUM NO. 1**

A handwritten signature in blue ink, appearing to read "Rick Castle", is written over a horizontal line.

Rick Castle  
Project Manager  
Issued February 5, 2021

## BID FORM

City of Roseburg  
900 SE Douglas Avenue  
Roseburg, Oregon 97470

The undersigned bidder has carefully examined the Contract Documents for the construction of the

**Airport Parking Lot Improvements**  
**20PW22**

referred to in the Invitation to Bid dated January 21, 2021, inviting bids on such Project and also the site of the Project. Bidder will provide all necessary labor, equipment, tools, apparatus and other means of construction, do all the work and furnish all the materials called for by said Contract Documents in the manner prescribed therein to provide a complete Project.

The undersigned bidder understands that the quantities of work as shown herein are approximate only, unless noted otherwise, and are subject to increase or decrease. The bidder offers to perform the work, at the unit price stated in the following schedule, whether the quantities are increased or decreased.

Schedule A – Base Bid						
Item No.	Item Name	Unit	Total Quantity	Spec Section	Unit Cost	Total Cost
1	Mobilization	LS	1	00210	\$	\$
2	Temporary Protect, and Direct of Traffic	LS	1	00225	\$	\$
3	Grading/Shaping/Compacting	SY	1400	00330	\$	\$
4	8-inch ADS WT Storm Sewer Pipe	LF	131	00445	\$	\$
5	Catch Basin	EA	1	00470	\$	\$
7	Agg Base for fine grading for ACP	TON	40	00600		
8	Level 2, 1/2 inch dense, MHMAC Mixture	TON	450	00744	\$	\$
9	Monolithic 12" curb/sidewalk 6.5' width	SF	468	00759	\$	\$
10	Monolithic 12" curb/ADA ramp 6.5' width	SF	189	00759	\$	\$
11	4" concrete sidewalk/ADA path 6' wide	SF	360	00759	\$	\$
12	Mono C/G/Driveway 6" Concrete Depth	SF	290	00759	\$	\$
13	Standard 12" curb	LF	12	00759	\$	\$
14	6" Curb	LF	166	00759	\$	\$
15	Striping	LS	1	00860	\$	\$
16	Furnish and place 4"-8" Gabion 9" depth	TON	36	00390	\$	\$
17	Furnish and place 1 1/2" River Rock 4" depth	TON	30	00390	\$	\$
18	Relocate Existing 1" Meter and install New backflow*	LS	1	01120	\$	\$
19	Install / cap 1" sch 40 irrigation line	LF	310	01120	\$	\$
20	Install Parking Wheel Stops	EA	9	00759	\$	\$
	* City to provide new boxes for water meter and backflow device					
Schedule A Bid Item Total:					\$	

Schedule B – Alternate Bid						
Item No.	Item Name	Unit	Total Quantity	Spec Section	Unit Cost	Total Cost
1	Fencing	LF	130	03010	\$	\$
2	Gate	LF	20	03010	\$	\$
<b>Schedule B Bid Item Total:</b>					<b>\$</b>	

\*Abbreviations

LS – Lump Sum                      CY – Cubic Yard                      EA – Each  
LBS – Pounds                      LF – Lineal Feet                      IN – Inches  
SY – Square Yard                      TONS – Tons

BIDS WILL BE EVALUATED ON THE SCHEDULE “A” BASE BID PRICE PLUS ANY OR ALL OF THE SCHEDULES CHOSEN BY THE OWNER. THE ORDER OF THE SCHEDULES LISTED ABOVE DOES NOT REPRESENT THE ORDER IN WHICH ANY OF THESE SCHEDULES MAY BE CHOSEN.

SCHEDULES LISTED IN THE BID FORMS WILL BE REVIEWED AND ACCEPTED OR REJECTED AT THE OWNERS OPTION. ACCEPTED SCHEDULES WILL BE IDENTIFIED IN THE CONSTRUCTION CONTACT.

**The undersigned also declares and agrees as follows:**

1. That the only persons or parties interested in this bid are those named herein, that the bid is in all respects fair and without fraud, and that it is made without any connection or collusion with any person making another bid on this Contract.
2. That the bidder, and any subcontractor upon which the bidder is relying, have carefully examined and had an opportunity to comment on, the Contract Documents for the construction of the proposed improvements including a full set of the plans and specifications, including all addenda thereto; that bidder has personally inspected the contemplated construction area or areas; that bidder is satisfied as to the adequacy and completeness of the plans and specifications, the feasibility of the work described therein, quantities of materials, items of equipment and conditions of work involved, including the fact that the description of work and materials as included herein are approximate only; and that this bid is made according to the provisions and under the terms of the Specifications which are hereto attached and hereby made a part of this bid.
3. All of the Specifications and Plans which are listed herein have been examined by the undersigned bidder and the terms and conditions thereof are hereby accepted.
4. It is understood that the Plans may be supplemented by additional Drawings and Specifications in explanation and elaboration of the Plans and it is agreed that such Supplemental Drawings, when not in conflict with those referred to in Paragraph 3

above, will have the same force and effect as if completed and attached hereto, and that when received, will be considered a part of the Contract Documents.

5. It is understood that all work will be performed under the price schedule outlined herein and that all services, materials, labor and equipment and all work necessary to complete the Project in accordance with the Plans and Specifications shall be furnished for the prices named in the bid. If there is a change in the scope of work or work which cannot be properly classified under the price schedule then bidder agrees to do this work as "extra work". The undersigned bidder agrees to do any extra work and furnish materials, and to accept as full compensation therefore at such prices as may be agreed upon in writing by the City and the Contractor before extra work begins. Each party binds itself to agree to reasonable prices.
6. It is understood the work to be performed must meet the highest standards prevalent in the industry or business most closely related to the work to be performed. It is further understood that failure to meet such standards may result in consequences including, but not limited to, a reduction or withholding of payment; a requirement that bidder perform, at bidder's own expense, additional work required to meet such standards; or termination of the contract, with damages being sought.
7. The bidder agrees that if this bid is accepted, the bidder will, within ten (10) calendar days after the notification of acceptance, execute the Construction Contract with the City in the form of Contract specified, and will, at the time of execution of the Contract, deliver to the City the Performance Bond, Payment Bond and Public Works Bond Filing Certification form as required herein, and will furnish all the materials necessary to complete the Project in the manner, in the time and according to methods as specified in the Specifications and required by the City.
8. The cash, certified check, cashier's check, irrevocable letter of credit or Bid Bond shall be payable to the City to the extent of 10% of the amount of the bid in case this bid is accepted by the City and the undersigned shall fail or refuse to execute the Contract and furnish a Payment Bond, a Performance Bond or the Public Works Bond Filing Certification form as required by the Specifications within the time limit named therein after notification that said bid is accepted, all in accordance with the provisions of this bid and the Plans and Specifications which are a part hereof.
9. All items for the Contract for which forms are provided herein have been completed in full by the showing of prices for each and every item thereof, and for the showing of other information indicated by the Bid Form.
10. Bidder agrees to begin work within ten (10) calendar days after the execution of the Contract proposed herein and receipt of the City's notification to begin work and to complete work in all respects within seventy (70) calendar days after "Notice to Proceed" has been issued by the City.
11. In the event the bidder is awarded the Contract and fails to complete the Project within the time limit or extended time agreed upon, as more specifically set forth in the General Conditions, liquidated damages shall be paid to or withheld by the City pursuant to Paragraph 4 of the Construction Contract (Time of Performance - Liquidated Damages)



at the rate of five hundred Dollars (\$500.00) per day, until the Project has been completed as provided in the General Conditions.

12. The undersigned bidder hereby states, as part of this bid, that the applicable provisions of Oregon's Prevailing Wage Law (ORS 279C.800 to 279C.870) and the Federal Prevailing Wage Law (Davis-Bacon Act, 40 U.S.C. 3141-3148), shall be complied with. When the Project is subject to both the State and Federal Prevailing Wage Laws and rates, workers in each trade will be paid the higher of the two rates.
13. The undersigned bidder and bidder's subcontractors shall comply with ORS 656.017, which requires them to provide Workers' Compensation coverage for all their subject workers.
14. The undersigned bidder hereby states, as part of this bid, that bidder shall comply with ORS 279C.505(2) which requires bidder to have an employee drug testing program in place.
15. The undersigned bidder and bidders' subcontractors shall comply with ORS 279C.570 and 279C.580, which require timely progress payments for public improvement projects and provide interest penalties for late payment.
16. The undersigned bidder hereby states, as part of this bid, bidder and bidder's subcontractors shall comply with the provisions of Exhibit "A" - "Standard City Contract Provisions".
17. If the bidder is awarded the Contract for this work, the name and address of the Surety who will provide the Payment Bond, Performance Bond and Public Works Bond (if required) will be:\_\_\_\_\_.
18. The name and address of the bidder who is submitting this bid is:\_\_\_\_\_, which is the address to which all communications pertinent to this bid and the Contract shall be sent. The bidder's email address is:\_\_\_\_\_.
19. The names of the principal officers of the corporation submitting this bid or of the partnership, or of all parties interested in this bid as principals are as follows:\_\_\_\_\_.
20. The undersigned bidder acknowledges that Addenda No. \_\_\_\_\_ through \_\_\_\_\_ have been delivered to bidder and have been examined as part of the Contract Documents.
21. In the prosecution of this work, the bidder proposes to use the subcontractors listed on the First-Tier Subcontractor Disclosure Form presented within two working hours of the bid submission deadline as set forth in the Invitation to Bid. Any bidder not using subcontractors subject to the above referenced Disclosure Form shall indicate "NONE" on the Disclosure Form and sign and submit the form as required.
22. Declaration of Residency: I "am" or "am not" (circle one) a "resident bidder"\* as defined by ORS 279A.120, a contractor that has paid unemployment taxes or income taxes in

Oregon during the 12 calendar months immediately preceding submission of the bid, has a business address in this state and has stated in the bid whether the bidder is a "resident bidder" pursuant to ORS 279A.120.

23. The bidder's Construction Contractors Board License Number or Landscape Contractors Board License Number is: \_\_\_\_\_.
24. Bidder's Tax Identification Number: \_\_\_\_\_. Email:\_\_\_\_\_.
25. Public Works Bond: If the bid is accepted, prior to beginning work on the project, the bidder will file with the Construction Contractors Board, a Public Works Bond in the amount of \$30,000 with a corporate surety authorized to do business in the State of Oregon; and before permitting a subcontractor to begin work on the project, the bidder will verify that the subcontractor has also filed the aforementioned bond. If the bidder, as a certified disadvantaged, minority, women or emerging small business enterprise, elects not to file the Public Works Bond, bidder will file written verification of such certification with the Construction Contractors Board and provide the Board and the City of Roseburg with notice of such election.
26. **If applicable** pursuant to Section 11 of "Information for Bidders", the undersigned bidder hereby states, as part of this bid, that bidder has completed pay equity compliance training and received a certificate of completion from the Oregon Department of Administrative Services. **(NEW)**

**If sole Proprietor or Partnership:**

In witness hereto, the undersigned as set his/her hand this \_\_\_\_\_ day of \_\_\_\_\_, 2021.

Printed name of bidder:\_\_\_\_\_

Signature of bidder:\_\_\_\_\_

Title:\_\_\_\_\_

**If Corporation:**

In witness whereof, the undersigned corporation has caused this instrument to be executed and its seal affixed by its duly authorized officers this \_\_\_\_ day of \_\_\_\_\_, 2021.

Name of Corporation:\_\_\_\_\_

Printed name of person signing:\_\_\_\_\_

Signature:\_\_\_\_\_

Title:\_\_\_\_\_

Attest: \_\_\_\_\_

Secretary



CITY OF ROSEBURG  
AIRPORT PARKING LOT IMPROVEMENTS  
CITY PROJECT# 20PW22

GENERAL NOTES:

1.

THE 2018 EDITION OF THE STANDARD SPECIFICATIONS FOR CONSTRUCTION PREPARED BY THE OREGON DEPARTMENT OF TRANSPORTATION AND THE AMERICAN PUBLIC WORKS ASSOCIATION OREGON CHAPTER AND THE LATEST EDITION OF THE CITY OF ROSEBURG DEPARTMENT OF PUBLIC WORKS SPECIFICATIONS AND STANDARD DRAWINGS WILL BE CONSIDERED THE STANDARD SPECIFICATIONS.
2.

TRENCH BACKFILL SHALL BE CLASS B (¾"-0" CRUSHED ROCK) WITH ALL STREET RIGHT OF WAYS AND UNDER ALL PARKING LOTS, AND CLASS A (SUITABLE EXCAVATED MATERIALS) ELSEWHERE, UNLESS SHOWN DIFFERENT ON TRENCH DETAIL OR IN SPECIFICATIONS. ALL TRENCHES WILL BE COMPACTED WITH HAND-OPERATED PNEUMATIC COMPACTOR. THE CONTRACTOR SHALL REPLACE ANY AND ALL SURVEY MONUMENTS WHICH ARE AFFECTED BY THE CONSTRUCTION. ALL MONUMENTS WILL BE RESET BY A OREGON LICENSED LAND SURVEYOR.
3.

LOCATIONS SHOWN ON ENGINEERING DRAWINGS ARE APPROXIMATE. THE EXACT LOCATION WILL BE STAKED OUT IN THE FIELD BY THE ENGINEER. CONTRACTOR TO GIVE SEVEN DAYS NOTICE TO ENGINEER FOR STAKES.
4.

INSULATED COPPER TONING WIRE APPROVED FOR DIRECT BURY SHALL BE PLACED IN ALL TRENCHES WHERE PIPE OR CONDUIT HAS BEEN LAID. ALL TONE WIRE SHALL BE TESTED PRIOR TO ACCEPTANCE.
5.

THE CONTRACTOR SHALL NOTIFY ALL AFFECTED UTILITY COMPANIES FOR LOCATIONS OF MAINLINE AND SERVICE LINE LOCATIONS PRIOR TO DIGGING. CONTRACTOR TO CONTACT ONE-CALL AT LEAST 48 HOURS PRIOR TO CONSTRUCTION AT 811. ATTENTION: OREGON LAW REQUIRES YOU TO FOLLOW RULES ADOPTED BY THE OREGON UTILITY NOTIFICATION CENTER. THOSE RULES ARE SET FORTH IN THE OAR 952-001-0090, AND OREGON LAWS 1995, CHAPTER 691, SECTION 7. YOU MAY OBTAIN COPIES OF THE RULES BY CALLING THE CENTER.
6.

ENGINEER AND CITY TO BE NOTIFIED FOR INSPECTION AS SHOWN ON SCHEDULE OR AS SPECIFIED IN "GENERAL NOTES" FOR THAT SPECIFIC CONSTRUCTION ITEM.
7.

CONTRACTOR TO FIELD VERIFY TYPE, LOCATION, AND ELEVATIONS OF EXISTING UNDERGROUND UTILITIES PRIOR TO INSTALLATION OF NEW PIPING. CONTRACTOR RESPONSIBLE FOR OBTAINING ALL REQUIRED PERMITS FOR WORKING WITHIN CITY RIGHT OF WAYS.
8.

10.
9.

COMPACTION TESTING IS REQUIRED ON ALL MAINLINE TRENCHES, SUBGRADE AND BASE ROCK MATERIALS. TESTING SHALL CONFORM TO SECTION 00405 FOR TRENCHES AND SECTION 00330 FOR SUBGRADE. AGGREGATE BASE MATERIAL SHALL BE PLACED IN CONFORMANCE WITH SECTION 00640 WITH THE EXCEPTION THAT COMPACTION OF EACH LAYER SHALL BE CONTINUED UNTIL A DENSITY OF NOT LESS THAN 95% OF MAXIMUM DENSITY AS DETERMINED BY AASHTO T99 (OR 90% AS DETERMINED BY ASTM D 1557 (OR ASHTO T180)). FREQUENCY OF TESTING SHALL BE A MINIMUM OF 3 TESTS PER LIFT. WHEN QUANTITY EXCEED 2000 TONS PER LIFT, THEN ADDITIONAL TESTING IS REQUIRED AT THE RATE OF 3 TESTS PER 2000 TONS. ALL TEST RECORDS SHALL BE SUBMITTED TO THE ENGINEER BY THE FOLLOWING DAY.
10.

11.
11.

STANDARD DRAWINGS SHOWN ON PLANS ARE SUBJECT TO CHANGE WITHOUT NOTIFICATION. CONTRACTOR TO VERIFY WITH CITY PRIOR TO CONSTRUCTION.
12.

A PRE CONSTRUCTION CONFERENCE WITH THE CITY SHALL BE HELD PRIOR TO ANY CONSTRUCTION.
13.

ALL ASPHALT PAVING SHALL BE LEVEL 2, ¾" DENSE HMAC PER SECTION 00744 OF THE STANDARD SPECIFICATIONS.
14.

CITY CREWS WILL PERFORM TV INSPECTION OF STORM DRAINAGE SYSTEM PRIOR TO FINAL PAVING, BUT AFTER ALL OTHER WORK IS DONE. CONTRACTOR TO REQUEST TV INSPECTION A MINIMUM OF 72 HOURS PRIOR TO INSPECTION.
15.

ALL CATCH BASIN AND CURB LINLETS ARE REQUIRED TO HAVE "DO NOT DRAIN - DRAINS TO STREAM" THERMOPLASTIC MARKINGS; INSTALLED AT DEVELOPER'S EXPENSE.
16.

12 GAGE STRANDED COPPER TONING WIRE WITH GREEN THHN INSULATION SHALL BE PLACED IN ALL TRENCHES WHERE STORM LINE HAS BEEN LAID. ALL TONING WIRE SHALL BE TESTED PRIOR TO ACCEPTANCE.
17.

ALL STORM LINE TIE-IN TO CATCH BASINS AND MANHOLES SHALL BE GROUTED TO A SMOOTH FINISH.

INDEX OF DRAWINGS

SHEET NO.	DESCRIPTION
1.	COVER SHEET
2.	DEMOLITION PLAN
3.	GRADING PLAN
4.	SITE PLAN
5.	LANDSCAPING PLAN
6.	STANDARD DETAILS 1
7.	STANDARD DETAILS 2

PROJECT LOCATION



CITY OF ROSEBURG  
Public Works Department  
Brice Perkins, P.E. – DIRECTOR

AIRPORT PARKING LOT  
IMPROVEMENTS  
20PW22  
COVER SHEET

DATE:	12/21/20	DESIGN:	RGC
	REVISIONS	DRAWN:	RGC
	1/4/21	SCALE:	NTS
		SHEET:	1/7



# Grading Plan

## Keyed Grading Notes

- ① Excavate 4" deep behind existing and new sidewalk 4' back from walk for landscaping rock tie in.
- ② Excavate 12" below existing surface between building and new back of walk for planters.
- ③ See elevation table for FG for new sidewalk ADA ramp, and ADA path.

EG = Existing Ground Elev.

EAC = Existing Asphalt Elev.

FAC = Finished Asphalt Elev.

NOTE: FINISH GRADES ARE APPROXIMATE AND MAY VARY UP TO 0.20' UPON FINAL GRADING

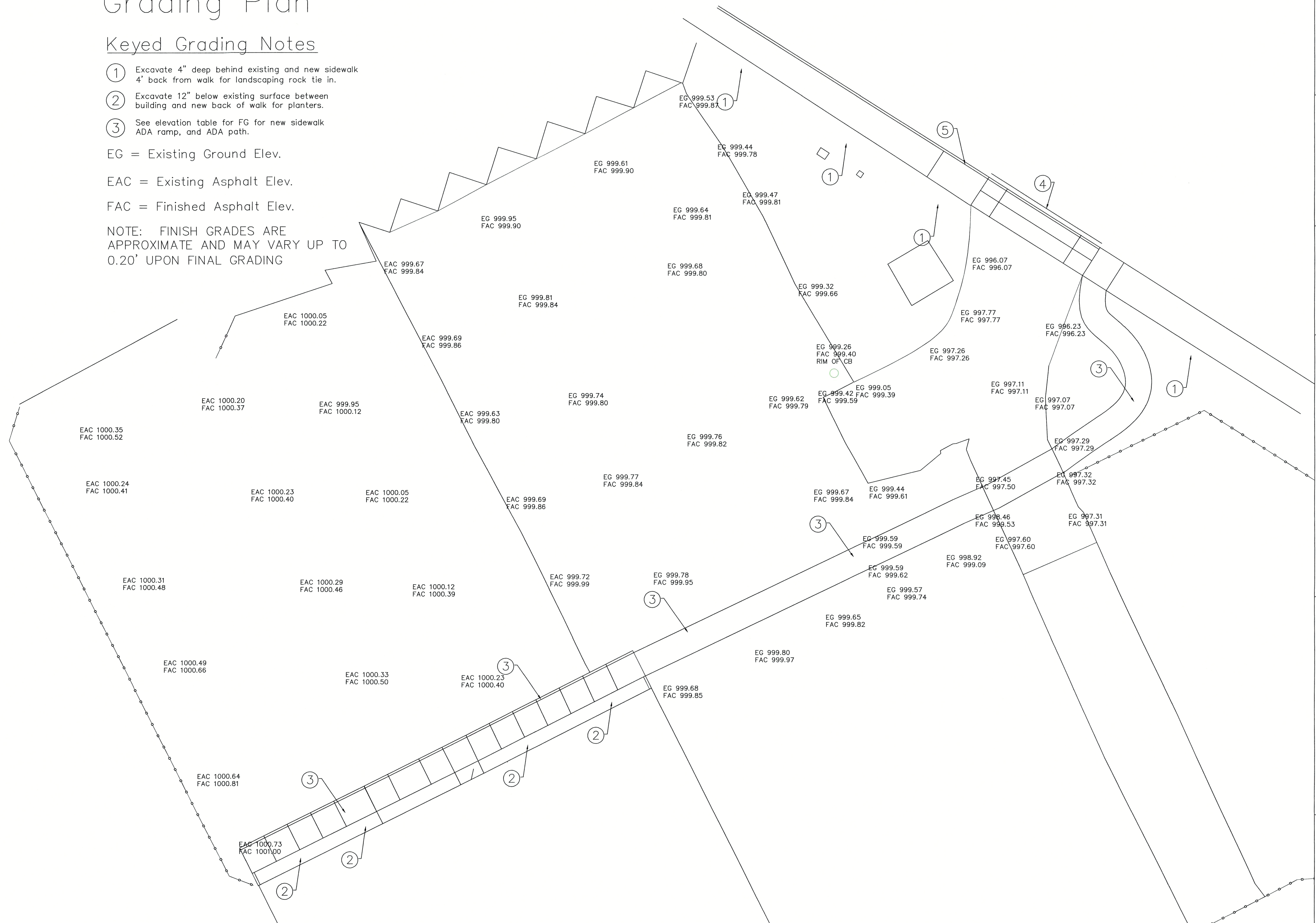

	DESIGN:	RGC
	DRAWN:	RGC
	SCALE:	1"=10'
	SHEET:	3/7
DATE: 12/21/20		REVISIONS
		1. 1/4/21
		2.
		3.
		4.
AIRPORT PARKING LOT IMPROVEMENTS		20PW22
CITY OF ROSEBURG Public Works Department Brice Perkins, P.E. - DIRECTOR		GRADING PLAN



Site Plan

- = 2" ACP Overlay
- = 4" ACP Overlay two lifts

- 1

Install gibson oil/water separator with flow guard filter or approved equal with 8" outlet. Place "Do not dump, drains to stream" stencil or permanent marking - see detail 1, sheet 6
- 2

Install approximate 131 linear feet of 8" n-12 WT ADS Storm Pipe from new catch basin into existing catch basin. Trench section per detail 7, sheet 6
- 3

Core opening into existing catch basin for 8" n-12 pipe. Cut pipe flush and grout to a smooth surface
- 4

Construct 6" Raised Curb. Approximately 80 lf. - See Detail 2, Sheet 6
- 5

Construct 6" Raised Curb. Approximately 44 lf. - See Detail 2, Sheet 6 - Block out a 10' opening for vehicle access to existing tower.
- 6

Construct 6" Raised Curb. Approximately 42 lf. - See Detail 2, Sheet 6
- 7

Construct ADA Ramp - See Detail 3, Sheet 6
- 8

Construct new monolithic 12" curb and 6' sidewalk - See Detail 4, Sheet 6
- 9

Construct 6' concrete sidewalk / ADA path- see detail 9, sheet 6
- 10

Construct ADA parking and landing area. Maximum cross slope is 2% see detail 1 sheet 7
- 11

10' x 18' parking stalls. 4" white paint.
- 12

Relocate existing water meter approximately 25' to the new landscaping island. Replace 1" PE lateral from the CORP at the 12" main and use new PE from water main to new meter and backflow location. Furnish and install new double check backflow device. City to furnish 2 water meter boxes for relocation and installation see details 1 & 2, sheet 5
- 13

Remove / Replace driveway - see detail 5, sheet 6
- 14

Replace damaged sidewalk panels. Saw cut behind existing curb / gutter. Dowel with #3 bar 9" in length every 4'. Approximately 84 sf. - see detail 6, sheet 6
- 15

ADA cross walk marking. 8" wide white stripe each side of 6' accessible path. Approximate 222 lf for both sides of accessible path.
- 16

Overlay 2" ACP over existing ACP parking lot - see detail 3, sheet 7
- 17

Pave 4" of ACP over regraded parking area - see detail 4, sheet 7
- 18

Construct 12" standard curb. approx. 8 lf. - see detail 8 sheet 6
- 19

Alternate Bid Schedule "B". Construct 6' chain link fence with 3 strands of barbed wire. The gauge, height, features will be the same as the adjacent fence - approximately 87 lf
- 20

Alternate Bid Schedule "B". Install 6' chain link fence gate on rollers on existing posts of the adjacent fencing. The gauge, height, features will be the same as the adjacent fence. Provide any additional posts if needed for the rolling gate installation. Gate will be 20' in length. The removal of the existing 8' swinging gate will be required.
- 21

Install nine (9) 6' wide parking bumpers 2' from face of curb - see detail 5 sheet 7

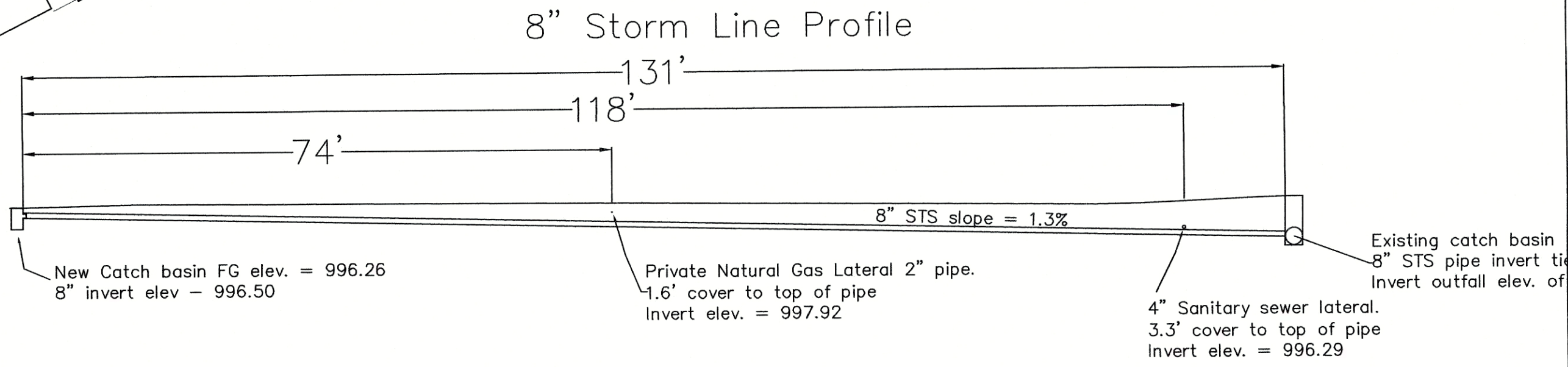
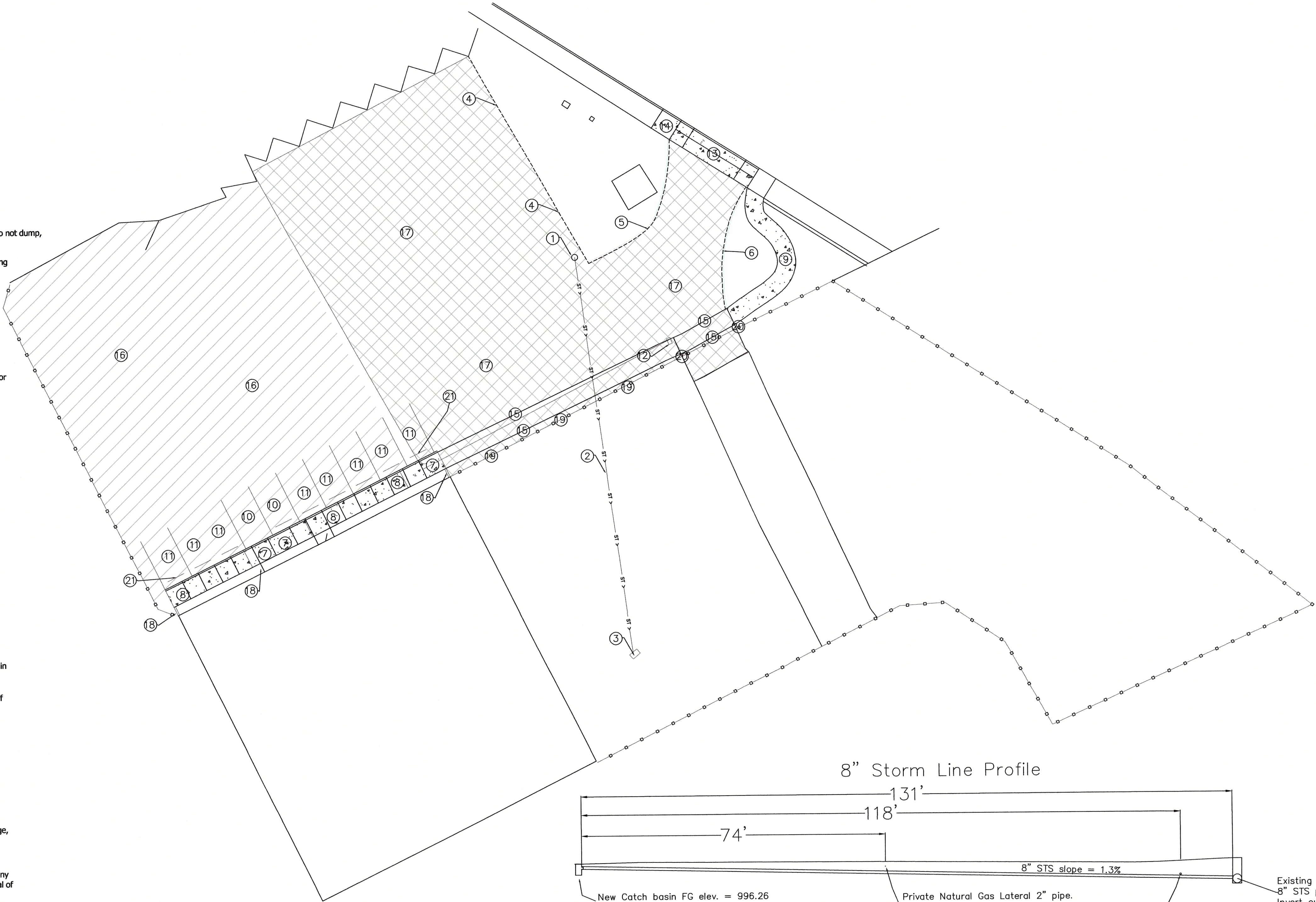

	DATE: 12/21/20	DESIGN: RGC
	REVISIONS	DRAWN: RGC
	1. 1/4/21	SCALE: 1" = 20'
	2.	SHEET: 4/7
AIRPORT PARKING LOT IMPROVEMENTS 20PW22		SITE PLAN
CITY OF ROSEBURG Public Works Department Brice Perkins, P.E. — DIRECTOR		