

ADDENDUM NO. 1
TO THE
CONTRACT DOCUMENTS
FOR
PROJECT NO. 20WA17
24-INCH TRANSMISSION MAIN
HOOKER ROAD TO ISABELL AVENUE
FOR
CITY OF ROSEBURG

THIS ADDENDUM IS HEREBY MADE A PART OF THE CONTRACT DOCUMENTS TO THE SAME EXTENT AS THOUGH IT WERE ORIGINALLY INCLUDED THEREIN.

BIDDERS MUST ACKNOWLEDGE RECEIPT OF ALL ADDENDA ON THE BID PROPOSAL FORM. BID PROPOSALS THAT FAIL TO ACKNOWLEDGE ALL ADDENDA MAY BE CONSIDERED IRREGULAR AND MAY BE REJECTED.

ISSUED THIS 26TH DAY OF MAY, 2021.



MURRAYSMITH
888 SW 5th, Suite 1170
Portland, OR 97204
(503) 225-9010

ITEM NO. 1 – VOLUME 1; BIDDING AND CONTRACT DOCUMENTS; PAGE 3 - ADVERTISEMENT FOR BID

- A. **REVISE** the third paragraph, as shown below (**revision are in bold**):

Bids are due by **2:30 p.m.** on **June 2, 2021**

All bids will be opened at **2:30 p.m.**

Additional forms disclosing first tier subcontractors are due by **4:30 p.m.**

No bids shall be received after this date and time.

ITEM NO. 2 – VOLUME 1; BIDDING AND CONTRACT DOCUMENTS; PAGE 4 – INVITATION TO BID

- A. **REVISE** the first paragraph, as shown below (**revision are in bold**):

The City of Roseburg will receive sealed bids or bids submitted via email marked "Bid for Project No. 20WA17, 24-Inch Transmission Main – Hooker Road to Isabell Avenue Project" until the hour of **2:30 p.m.** on **Wednesday, June 2nd, 2021**, at which time they will be publicly opened and read. When required by ORS 279C.370, bidders must submit a list of their first-tier subcontractors providing labor, or labor and materials, no later than **4:30 p.m.** that same day. Bids shall be addressed and delivered to Amy L. Sowa, City Recorder, City Hall, 900 SE Douglas Avenue, Roseburg, Oregon 97470, or emailed to info@cityofroseburg.org. Any and all bids received after the **2:30 p.m.** deadline for submission, or for which the list of first-tier subcontractors has not been submitted by **4:30 p.m.** that same day, shall be considered nonresponsive and returned to the bidder. All bidders must list their "Construction Contractors Board" or "State Landscape Contractors Board" license number as required by ORS 701.021 or 671.530 on the bid form.

ITEM NO. 3 – VOLUME 1; SPECIFICATION SECTION 01 12 16, WORK SEQUENCE AND SCHEDULE CONSTRAINTS

- A. On page 01 12 16 - 3, in Section 3.1 – GENERAL REQUIREMENTS FOR EXECUTION OF WORK, **ADD** subsection included below:

"N. It is anticipated the Notice to Proceed will be issued no sooner than the week of July 26, 2021."

ITEM NO. 4 – VOLUME 1; SPECIFICATION SECTION 01 12 16, WORK SEQUENCE AND SCHEDULE CONSTRAINTS

- A. On page 01 12 16 - 5, in Section 3.2 – RECOMMENDED SEQUENCE OF CONSTRUCTION REQUIREMENTS AND CONSTRAINTS, **REPLACE** subsections 1 and 3 of Paragraph E with the following:

- “1. Coordinate with City to obtain Right of Entry from property owner prior to relocating existing steel mesh fencing and other obstructions, and entering property to install above ground, temporary HDPE feeder to NE Mary Ann Lane.”
- “3. Provide surface restoration and reinstall steel mesh fencing as required on private property after 30” Transmission Main has been permanently placed back in service as described below in 3.2G.”

ITEM NO. 5 – VOLUME 1; SPECIFICATION SECTION 01 22 20, UNIT PRICE MEASUREMENT AND PAYMENT

- A. On page 01 22 20 – 8 in the second sentence of Paragraph 1.26 (Bid Item No. 26. – Temporary Feeder to Mary Ann Lane), **REPLACE** the words “... removal and replacement of existing wood fence sections as required..” with “...relocation and reinstallation of steel mesh fencing and other obstructions as required.....”.
- B. On page 01 22 20 – 8 in the third sentence of Paragraph 1.26 (Bid Item No. 26. – Temporary Feeder to Mary Ann Lane), **REPLACE** the words “... excluding wooden fence replacement as required..” with “...excluding relocation and reinstallation of steel mesh fencing and other obstructions as required.....”.

ITEM NO. 6 – VOLUME 1; SPECIFICATION SECTION 26 42 01, CORROSION MONITORING SYSTEM FOR DUCTILE IRON PIPE

- A. On page 26 42 01 – 8, Section 2.11B., **REPLACE** Paragraph 1 with the following:
 - 1. Insulating Gasket: Insulating gasket retainers shall be full face, Type E, NEMA G-10 glass reinforced epoxy retainers with an Ethylene Propylene Diene Monomer (EPDM) rubber rectangular cross section O-ring seal. Minimum total gasket thickness shall not be less than 1/8-inch. The gasket shall have the same outside diameter as the pipe flange. At valve to pipe connections where the inside diameters are not equal, the gasket’s inside diameter shall be equal to the smaller of the two inside diameters. Dielectric strength shall be not less than 550-volts per mil, and compressive strength shall be not less than 50,000-psi. The manufacturer’s name and date of manufacture shall be marked on both sides of the gasket with minimum two-inch tall block letters using a durable marking ink or paint. The gasket shall be installed within 6 months of its date of manufacture. Do not store insulated flange gaskets at jobsites under direct sunlight or at temperatures exceeding 110 degrees Fahrenheit. Insulating gasket shall be PSI Linebacker, as manufactured by GPT, or equal.

ITEM NO. 7 – VOLUME 2; DRAWINGS

- A. **REPLACE** Sheet C-8, CONNECTION DETAILS – 1 (17 OF 31), **WITH** the attached updated sheet.

G:\PDX_Projects\20\2938 - 24-Inch, Hooker Rd To Isabell Ave\CAD\Sheets\20-2938-OR-C.dwg C-8 5/25/2021 1:04 PM MATT. ESTEP 23.0s (LMS Tech)

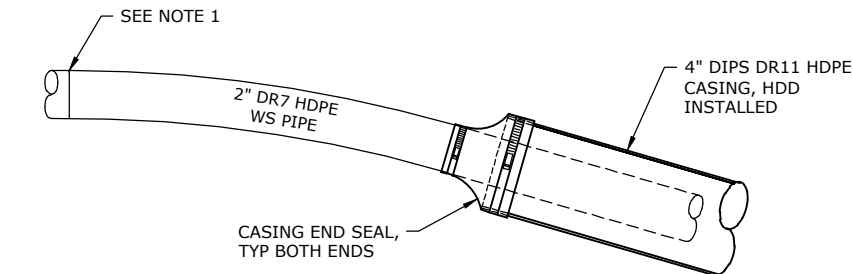
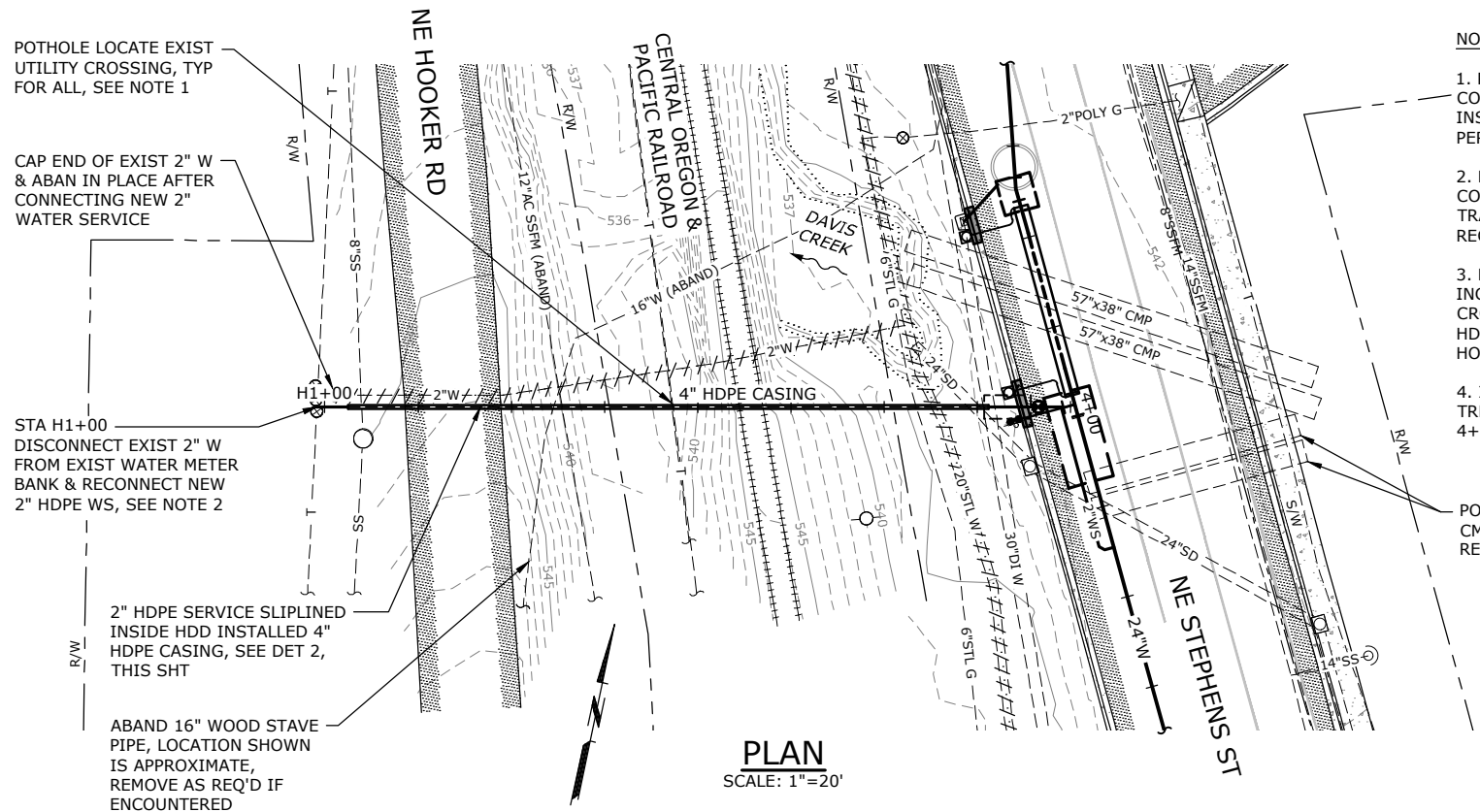

NOTE:

1. JOINTS IN HPDE SERVICE, AS APPROVED BY OWNER'S REPRESENTATIVE, SHALL BE BUTT FUSED.

2" HDPE SERVICE SLIPLINED INSIDE HDD INSTALLED 4" HDPE CASING

SCALE: NTS

2

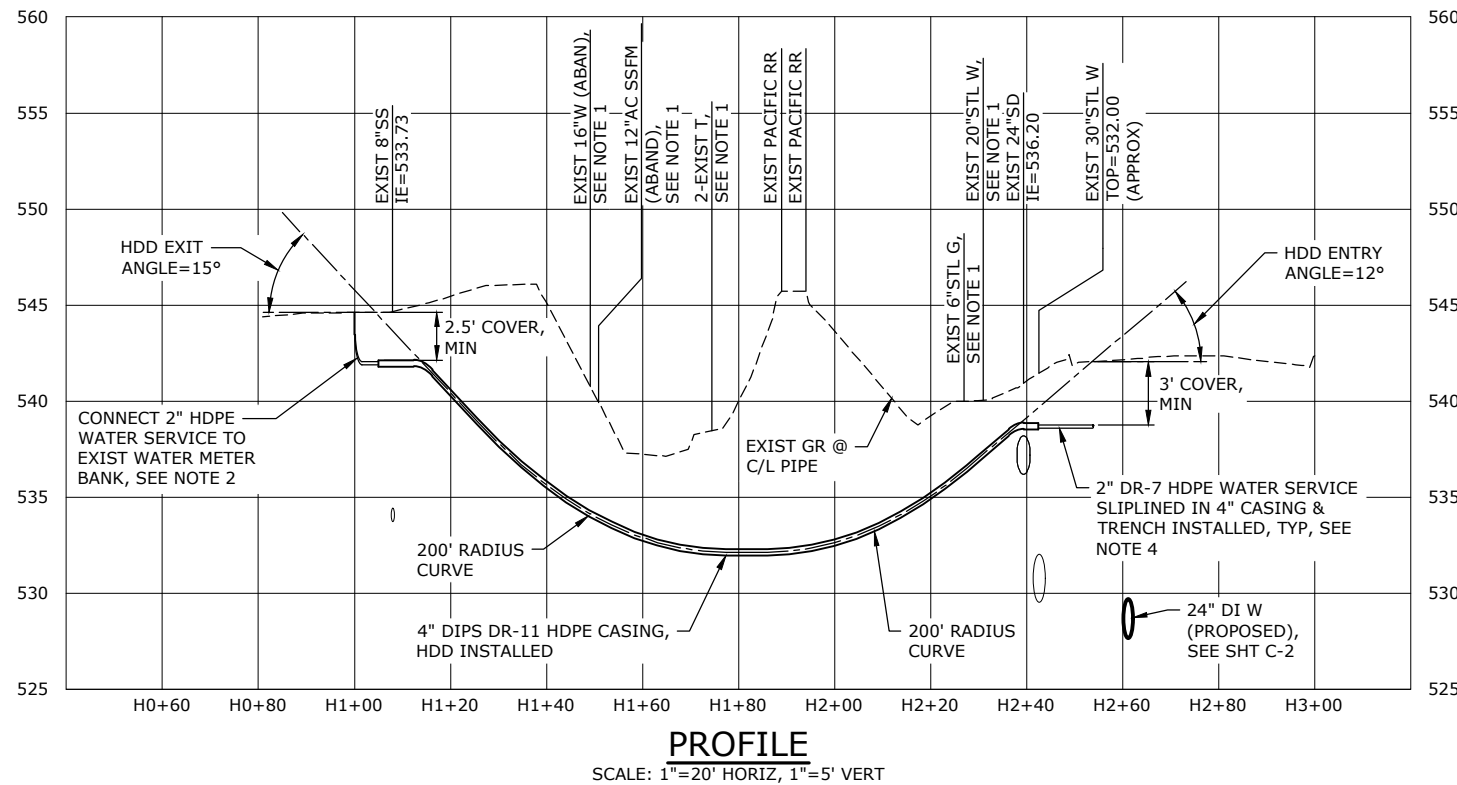

HDD WATER SERVICE REPLACEMENT PLAN AND PROFILE

SCALE: 1"=20'

1

C-2

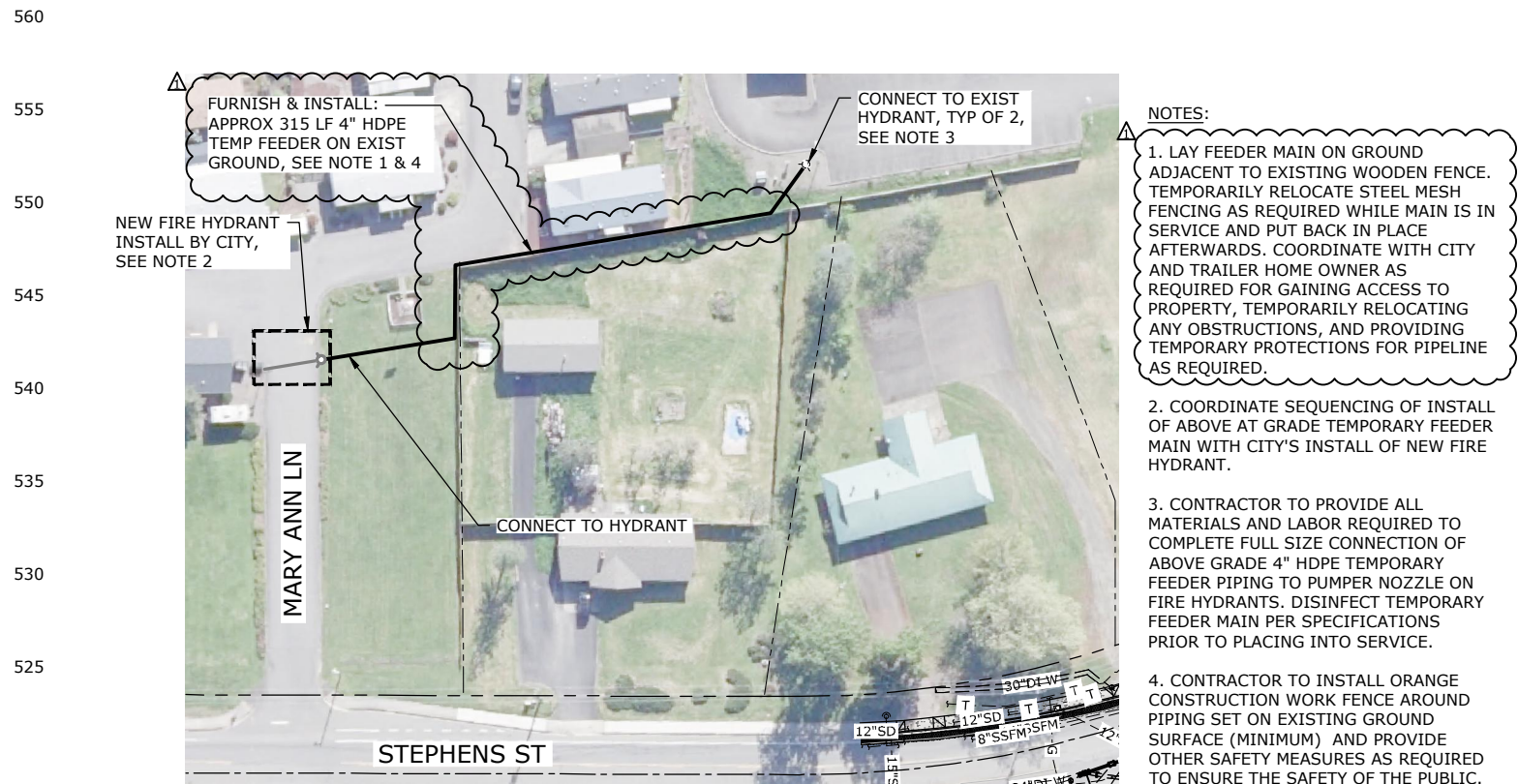

TEMPORARY FEEDER MAIN FOR MARY ANN LANE

SCALE: 1"=50'

3

NO.	DATE	BY	REVISION
1	05/26/21	JRL	ADDENDUM NO. 1

NOTICE

0 1/2 1

IF THIS BAR DOES NOT MEASURE 1" THEN DRAWING IS NOT TO SCALE

KTH
DESIGNED
DKH
DRAWN
JRL
CHECKED



murraysmith



PROJECT #20WA17

24-INCH TRANSMISSION MAIN

HOOKEER ROAD TO ISABELL AVENUE

CONNECTION DETAILS - 1

PROJECT NO.: 20-2938 SCALE: AS SHOWN DATE: MAY 2021

SHEET

C-8

17 of 31